

ACO CABLEMATE®

POLYCRETE® PIT INSTALLATION DRAWING



DRWG# XCPR-GP-3

With Rhinocast® Recessed Cover

www.aconz.co.nz

Pavers: For 30000kg Nominal Wheel Load

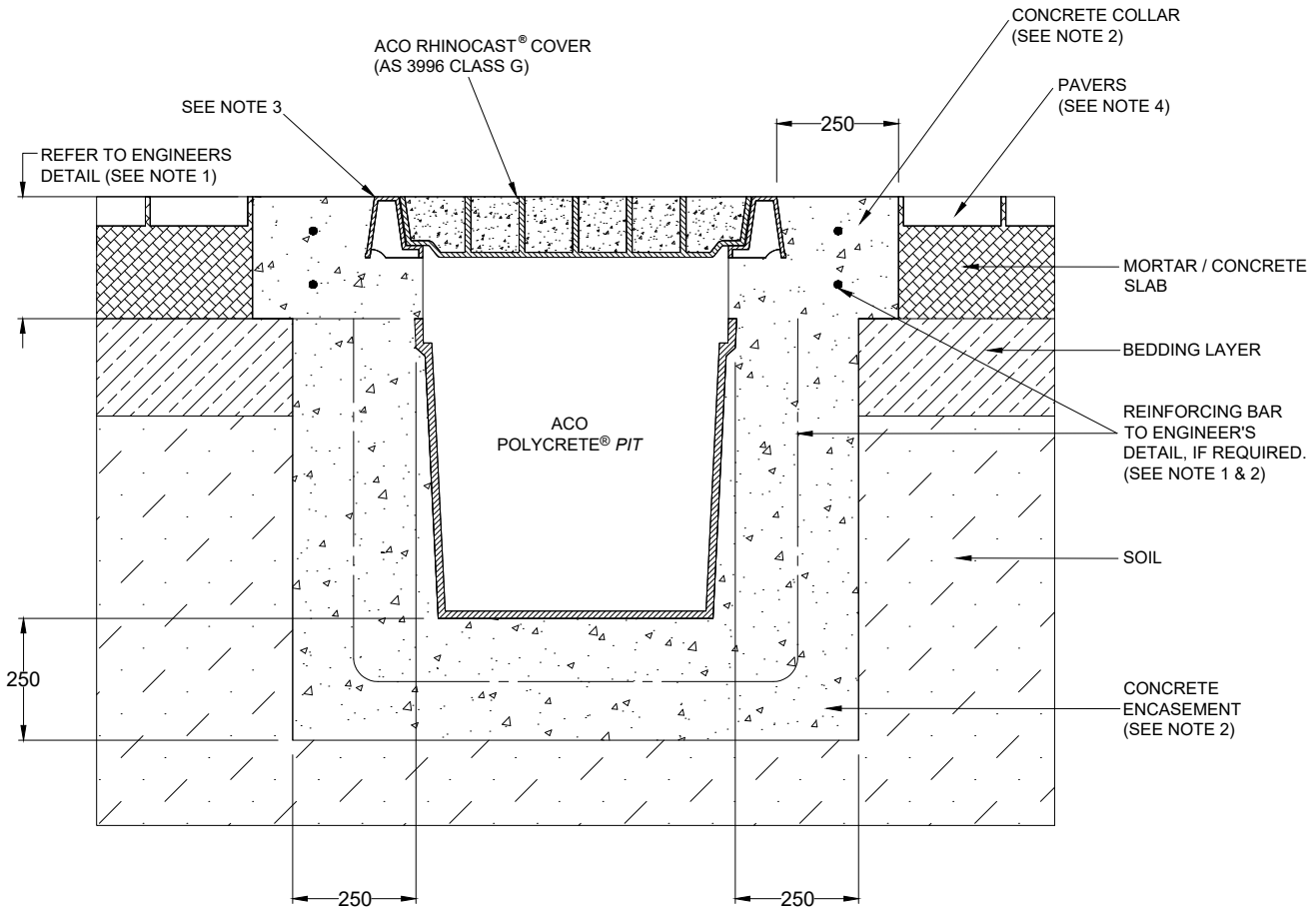

NOTES:

1. Specific site conditions may require an increase in these dimensions or reinforcement. It is the customer's responsibility to ensure the installation drawing is detailed for the application and the pit structure is protected from undue stress. *Engineering advice may be required.*
2. A minimum concrete strength of 25MPa is recommended. The concrete should be vibrated to eliminate air pockets.
3. The finished level of the concrete collar must be flush with the top of the frame.
4. The paver course adjacent to the concrete collar must be flush with the collar and must be fully bonded to the mortar/concrete slab.
5. Refer to ACO's latest installation instructions for complete details.

ACO CABLEMATE®

POLYCRETE® PIT SPECIFICATION CLAUSE

ACO Limited
 Unit F/6 Percival Gull Place
 Mangere, Auckland 2022
 Tel: 0800 448 080
 Fax: +64 9255 5114
 Email: info@aconz.co.nz

DRWG# XCPR-GP-3

With Rhinocast® Recessed Cover

www.aconz.co.nz

The cable enclosure(s) (for a nominal wheel load of 30000kg) with a *clear opening(s)* of shall be **Polycrete® Pit(s) Type (s)** and *part no.(s)* with **Rhinocast®** Recessed / Solid Top cover(s) and *part no.(s)*

All materials and components within the scope of the system shall be obtained from ACO and the work shall be carried out as specified in accordance with the manufacturer installation recommendations.